

NOTE: DO NOT OVER DRIVE FASTENERS.

FASTENING SCHEDULE WILL VARY
DEPENDING ON SPECIFIC APPLICATION

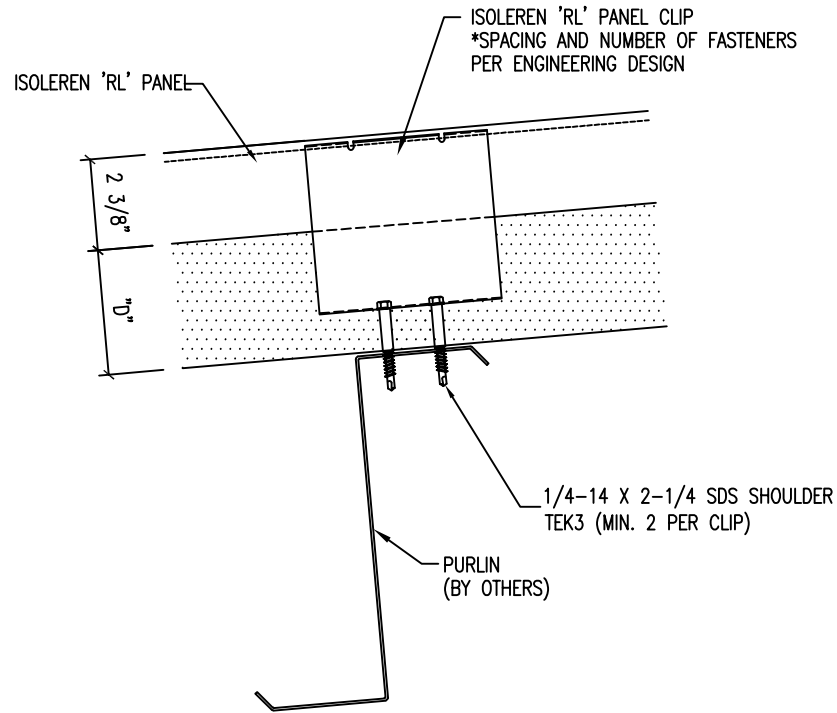

NOTE:

1. "D" = ROOF PANEL THICKNESS (AVAILABLE THICKNESS = 2.5, 3, 4, 5 OR 6)

** THE DETAIL SHOWN IS SUBJECT TO CHANGE WITHOUT NOTICE.



ATAS INTERNATIONAL, INC
Allentown PA
610-395-8445
Mesa AZ
480-558-7210

REV. NO.	DATE	DESCRIPTION OF REVISION	BY	APP

TITLE		Roof-Clip Connection	
DWG. NO.	DR	DATE	
MATERIAL	APP	DATE	
	SH. SIZE	SCALE	X:X