

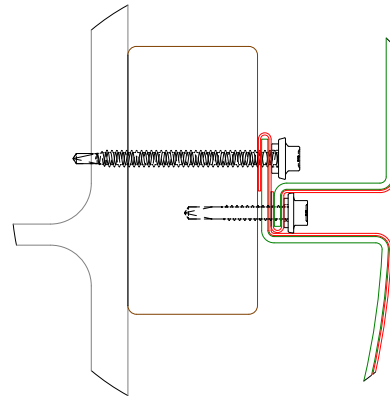

**Materials:**

18Ga 55% Al-Zn Alloy Coated Steel with Acrylic Coating  
 .032 Aluminum Shroud, Customer Specified Color

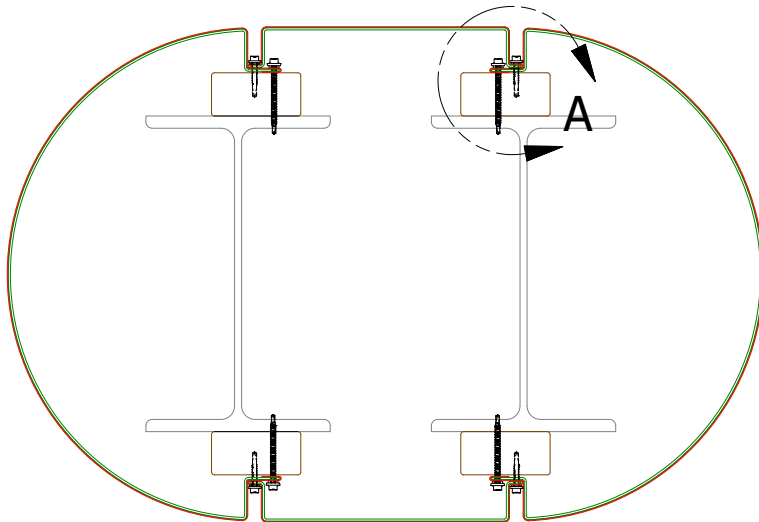

**DETAIL A**

**ATAS INTERNATIONAL, INC**  
 Allentown PA  
 610-395-8445  
 Mesa AZ  
 480-558-7210

TITLE				VISUAL RELIEF COLUMN COVER	
DWG. NO.				DR	DATE
				WH	8/18/2025
				APP	DATE
MATERIAL				SH. SIZE	SCALE
				A	X:X
REV. NO.	DATE	DESCRIPTION OF REVISION	BY	APP	