

**ATAS International, Inc.**  
Sustainable Solutions For A Better Future

# CEILING & SOFFIT SYSTEMS

Exterior Applications



ESSEX COUNTY  
Monte Irvin Orange Park

Empire Expo Center  
Syracuse, NY  
Wind-Lok Soffit in Medium Teak



# CONTENTS

## CEILINGS:

Carrier for Suspended Ceiling Systems .....	3
Lineair Linear Ceiling™ .....	4
Opaline™ .....	5

## SOFFITS:

Wind-Lok Soffit® .....	6
Additional Soffit Options .....	7

ON THE COVER: Lineair Linear Ceiling in Bone White | Monte Irving Community Center | Orange, NJ

# CARRIER FOR SUSPENDED CEILING SYSTEMS

The carrier is prepunched and roll formed from prepainted .040 aluminum. The standard length of the carrier is 12'. Holes are prepunched in the top and sides for easy hanging.

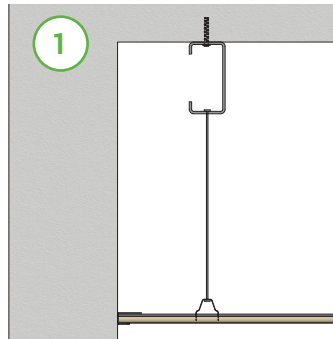

## SUGGESTED INSTALLATION TECHNIQUES

**1, 2, 3 & 4.** The simplicity of the installation speaks for itself. The carrier is suspended by wires or rigid frame. The panel is snapped onto the carrier with or without filler strips. The system can also be directly attached to the substructure. The carrier for the Linear Linear Ceiling system is available in .040 aluminum. The carrier track repeats in 4" increments making the different sizes of ceiling panels interchangeable.

For proper installation, allow a 1/8" space between panels\* for thermal movement. It is recommended that this hairline connection should be at least 4'-0" and three courses apart on a staggered formation.

**5.** The splice should be made at the center of the carrier, or use a splice plate to make the connection. Factory lengths are recommended to reduce distortion. The splice pieces are available in the same quality material as the panels. Another effect can be accomplished by dividing the ceiling into equal parts and using an H channel between sections.

**6.** When air circulation is desired, the filler can be omitted.

**7.** For acoustical efficiency, simply lay a low density black fiberglass blanket across the top of the panels between the carriers.

**8.** For unusual ceiling treatments or aesthetic design reasons, the ceiling system can be installed on a curve. The panels should be installed on a radius carrier which will need a solid support by others. The length of the radius carrier is 12'-0".

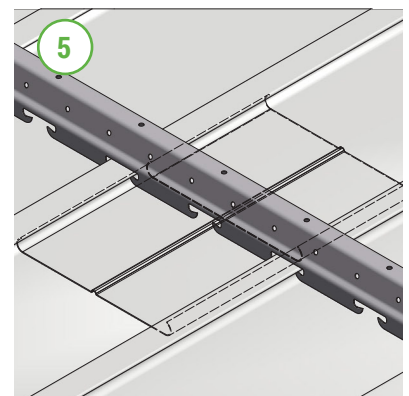
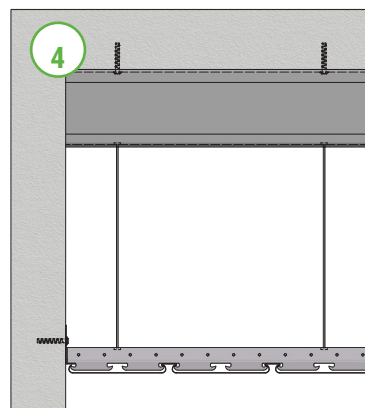
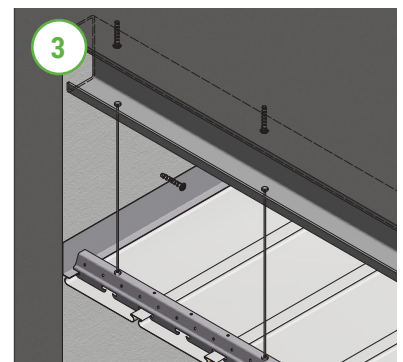
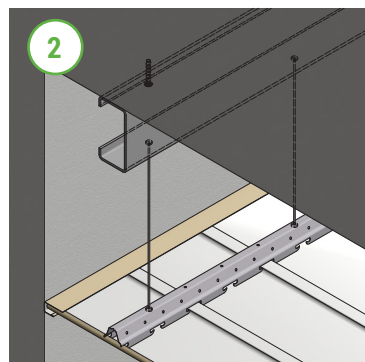

**6**

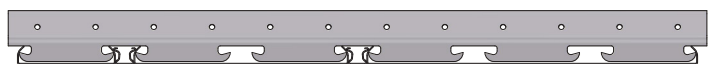
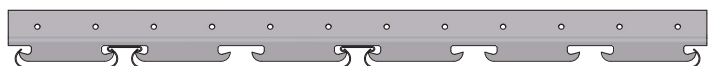

**7**

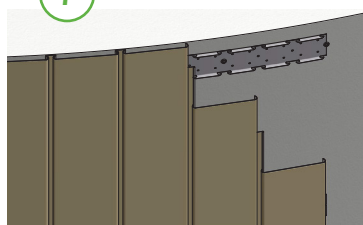

**8**

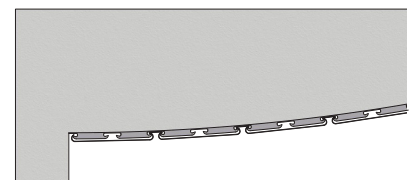

\*where panels meet end to end

## ROUND EDGE:

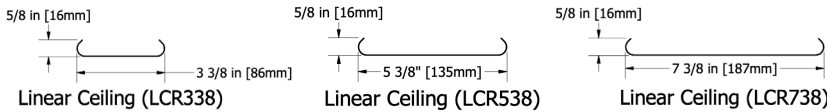
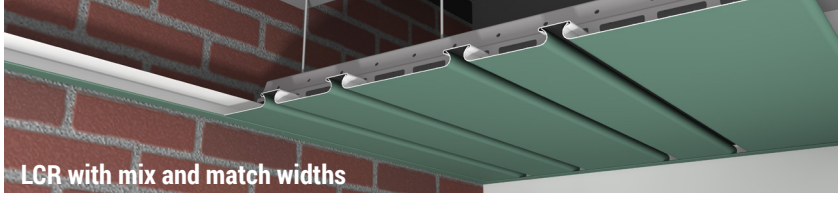
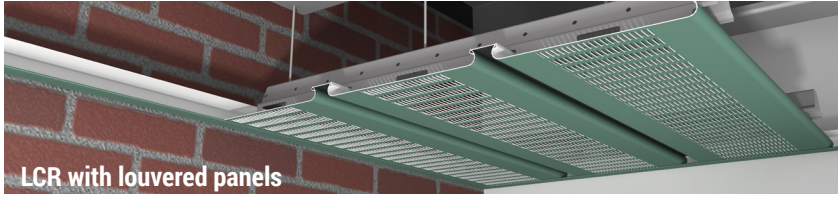
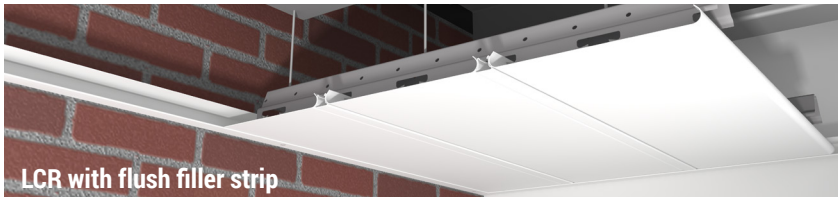
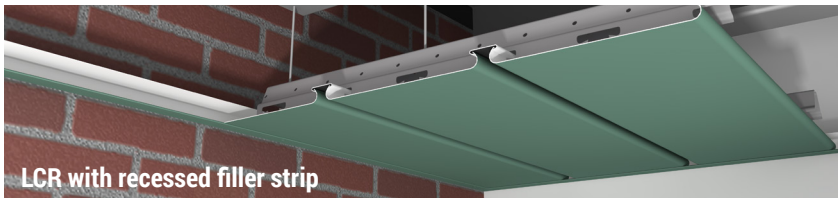

## BOX STYLE:

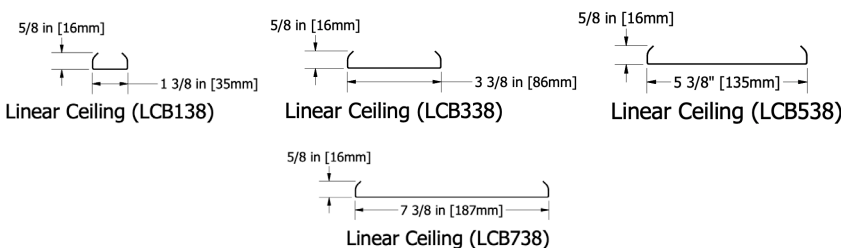
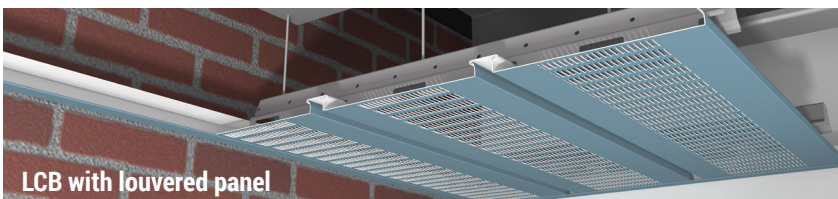
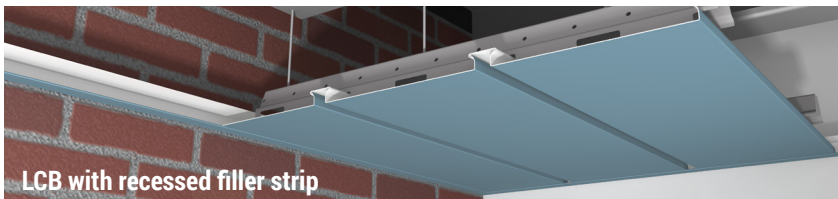

## LINEAIR LINEAR CEILING™ SUSPENDED CEILING DESIGN

SKU:

Round Edge: LCR338, LCR538, LCR738

Box Style: LCB138, LCB338, LCB538, LCB738

### MATERIAL

.019 (only available for LCB338 & LCR338),  
.024, .032 aluminum

### PANEL SPECS

LCR Width: 3<sup>3</sup>/<sub>8</sub>", 5<sup>3</sup>/<sub>8</sub>", 7<sup>3</sup>/<sub>8</sub>" | 4", 6", 8" coverage  
with filler strips

LCB Width: 1<sup>3</sup>/<sub>8</sub>", 3<sup>3</sup>/<sub>8</sub>", 5<sup>3</sup>/<sub>8</sub>", 7<sup>3</sup>/<sub>8</sub>" | 2", 4", 6", 8"  
coverage with filler strips

Length: Minimum 4'-0", maximum 20'-0"  
(LCB138 is limited to a 12' length)

Height: 5/8"

### TEXTURE

Smooth

Wood Grain Embossed (.032 aluminum only)

### FINISH

70% PVDF, Mirrored, Wood Grain Finishes

### COLORS

Choice of over 40 stock colors in .032 aluminum  
.019 and .024 aluminum available in Bone White  
with a 70% PVDF finish.

*Custom colors available\**

### ANODIZED

Clear Satin, Dark Bronze

### ACCESSORIES

Suspended carrier, a complete line of  
trims available

### CARRIER

Metal: Aluminum

Gauge: .040

Length: Standard 12'-0"

### FILLER STRIPS (OPTIONAL)

Available in .019 aluminum in Black  
or Bone White

*\*Subject to minimum quantities and extended lead time.  
Inquire for material and panel coverage availability.*

### FILLER STRIP.

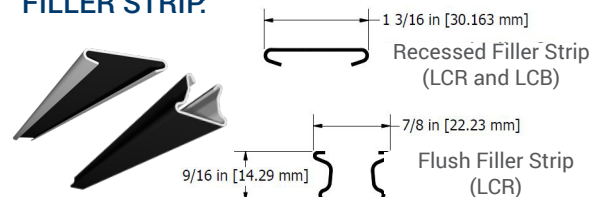

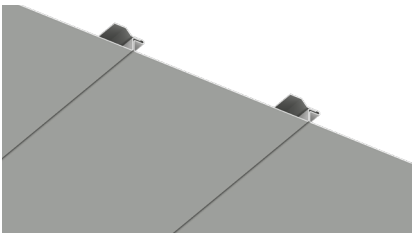

OPF

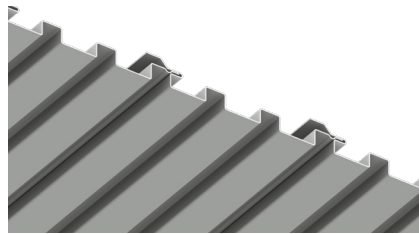

OPM

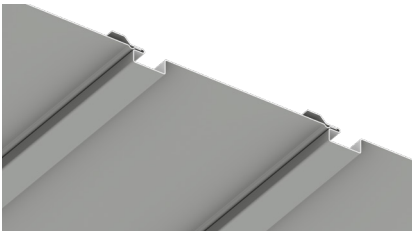

OPN

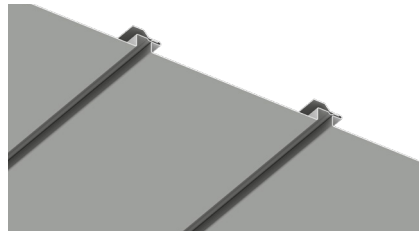

OPW

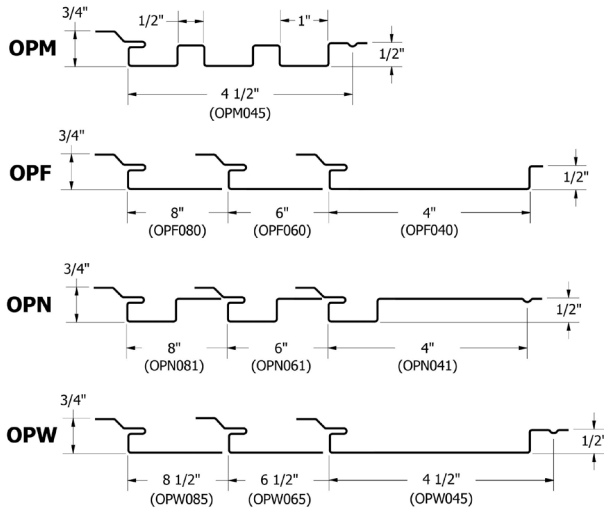

## OPALINE™

SKU: OPF, OPM, OPN, OPW

### MATERIAL

.032, .040 aluminum  
24 ga. metallic coated steel

### PANEL SPECS

Coverage: OPF: 4", 6", 8"  
OPM: 4 1/2"  
OPN: 4", 6", 8"  
OPW: 4 1/2", 6 1/2", 8 1/2"  
Minimum Length: 1'-6"  
Depth: 3/4"

### TEXTURE

Smooth, Stucco Embossed, or  
Wood Grain Embossed

### FINISH

70% PVDF, Wood Grain Finishes

### COLORS

Choice of over 40 stock colors  
Custom colors available\*

### CARRIER

Opaline is available with a suspended  
snap-in carrier or the panels can be  
mechanically attached to rigid substrate.

\*Subject to minimum quantities and longer lead time.  
Inquire for availability.



Flush Opaline (OPF) Ceiling with Snap In Carrier



Reveal Opaline (OPW) Ceiling with Snap In Carrier

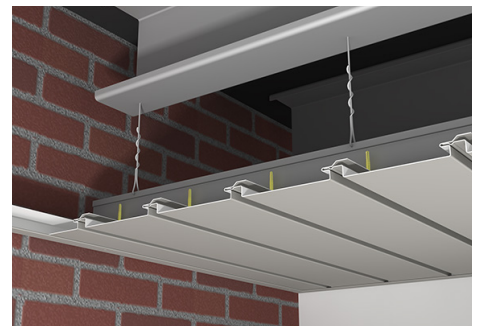

Reveal Opaline (OPW) Ceiling with Snap In Carrier  
Mechanically Attached to a Drywall Grid

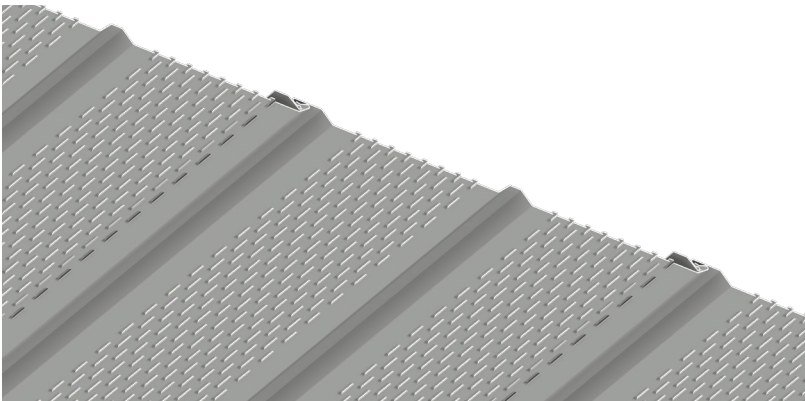

## WIND-LOK® SOFFIT

V-GROOVE DESIGNED PANEL

SKU: MPS120, MPV120

### MATERIAL

.019, .024, .032 aluminum

### PANEL SPECS

Coverage: 12"

Length: 12'-0", special lengths are available with an 8'-0" minimum, maximum 25'-0"

Height: 3/8"

### TEXTURE

Smooth, Stucco Embossed, Lanced, or Wood Grain Embossed (.032 aluminum only)

### FINISH

70% PVDF

### COLORS

Choice of over 40 stock colors in .032 aluminum, .019, .024 aluminum available in Bone White only. Custom colors available\*

### ANODIZED

Clear Satin, Dark Bronze (MPS120 only)

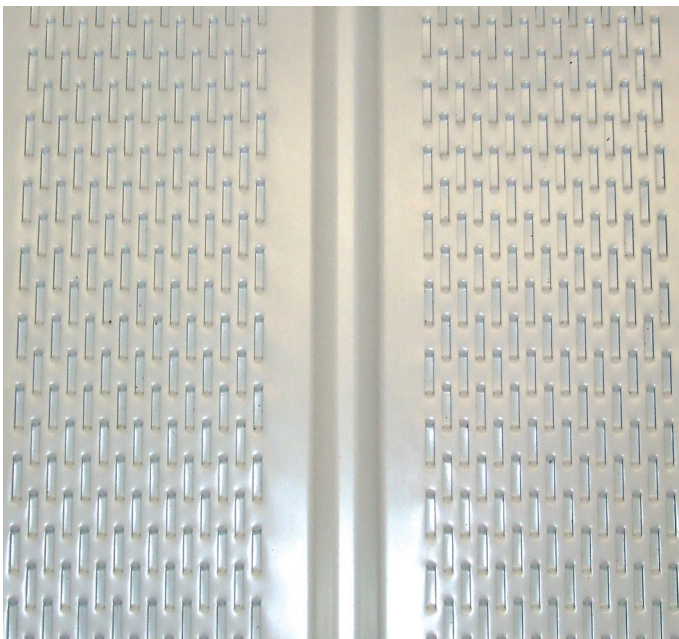
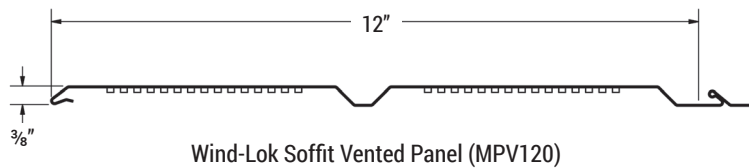
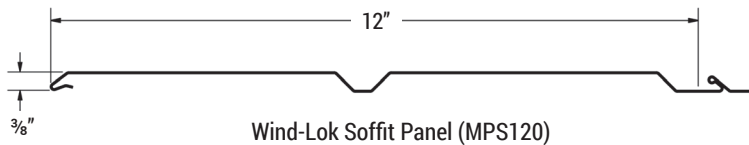

Vented Wind-Lok Soffit Panels allow air circulation, to help in the reduction of interior condensation. They are installed by the patented **"hook, pull, and fasten"** system, which allows for quick and easy installation with concealed fasteners. Panels may be solid or vented. Typical applications for Wind-Lok are wide overhangs and ceilings on porches, breezeways, carports and patios.

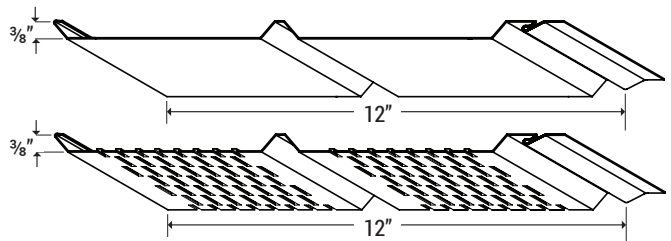

## ADDITIONAL SOFFIT OPTIONS



### FLUSH

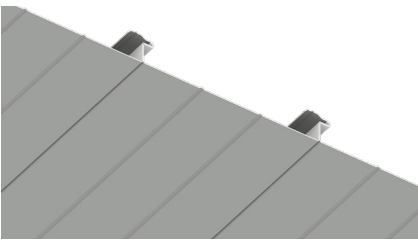

DESIGN WALL, DSF

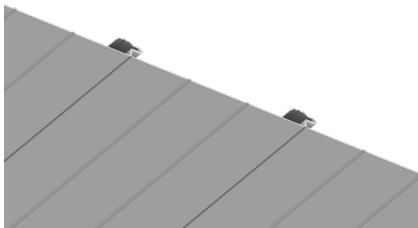

DESIGN WALL, DWF

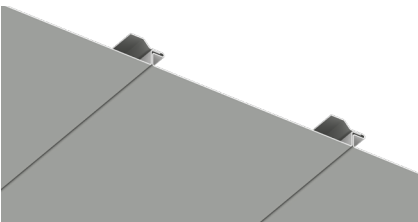

OPALINE, OPF

### REVEAL

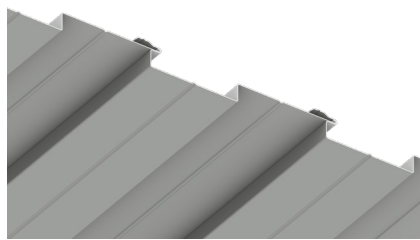

DESIGN WALL, DSH

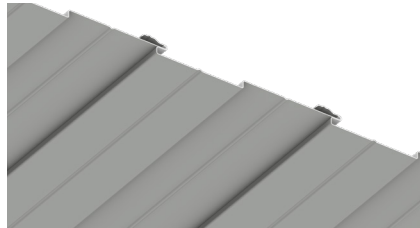

DESIGN WALL, DWH

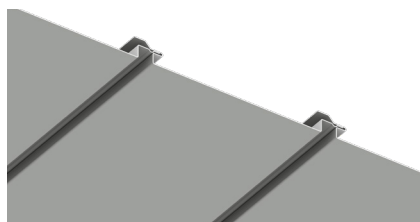

OPALINE, OPW

### RIBBED

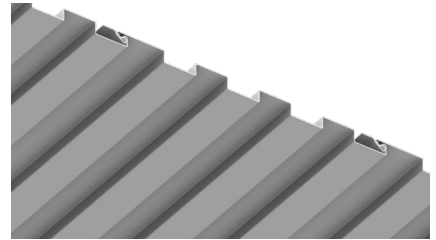

METAFOR, MFP

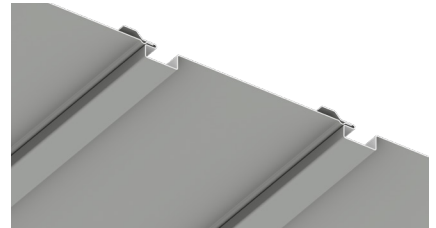

OPALINE, OPN

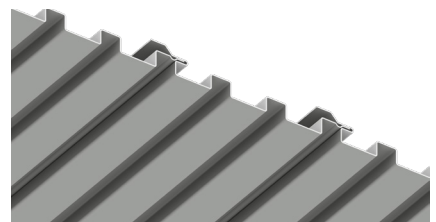

OPALINE, OPM

### FLUSH & LOUVERED/VENTED OPTIONS

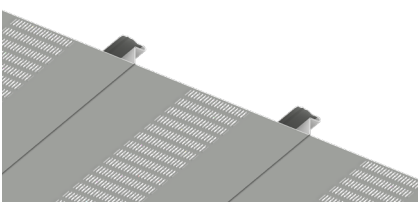

DESIGN WALL, DSF120  
WITHOUT STIFFENING RIBS, LOUVERED

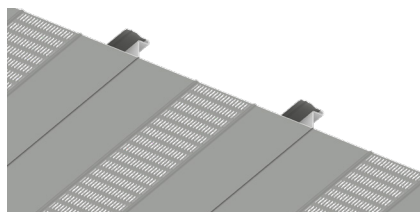

DESIGN WALL, DSF120  
WITH STIFFENING RIBS, LOUVERED

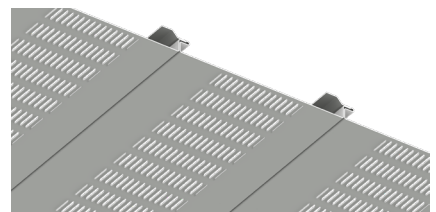

OPALINE, OPF, LOUVERED

# COLOR CHART

## Stock Colors | 70% PVDF Finish



Black (02)

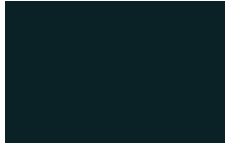

Classic Bronze (01)



Medium Bronze (03)



Hartford Green (27)



Forest Green (11)



Teal (19)



Hemlock Green (30)



Patina Green (12)



Chocolate Brown (04)



Boysenberry (25)



Redwood (07)



Mission Red (08)



Sierra Tan (09)



Rawhide (15)



Concord Cream (05)



Almond (36)



Sandstone (06)



Regal Blue (18)



Slate Blue (21)



Siam Blue (14)



Rocky Grey (16)



Charcoal Grey (62)



Slate Grey (20)



Dove Grey (13)

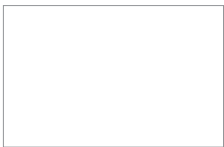

Ascot White (10)

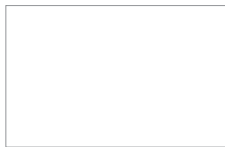

Bone White (26)

### Oxide Series

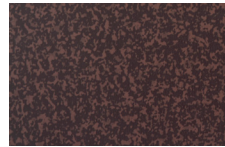

Tarnished Red (47)

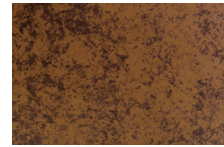

Copper Brown (42)

## Premium Colors | 70% PVDF Finish



Antique Patina (24)



Champagne (31)



Coppertone (23)

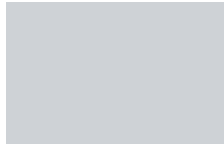

Titanium (35)



Silversmith (28)



Brite Red (17)

## Woodland Series



Birch (57)

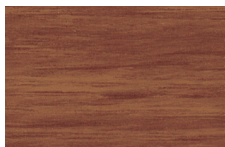

Cedar (54)



Driftwood (53)

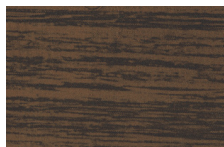

Walnut (55)

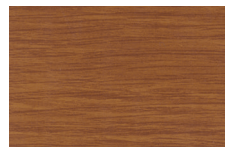

Bamboo (81)

## Matte Colors



Matte Black (32)

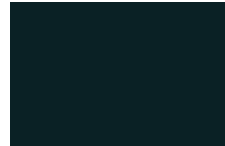

Char Brown (29)



Thunder Grey (34)



Anchor Grey (37)



Ash Grey (33)

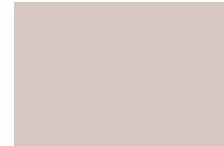

Almond (36)

For additional color offerings, visit [www.atas.com/colors](http://www.atas.com/colors). For current SRI values and agency listings refer to our Color and Reference Guide: [www.atas.com/sri](http://www.atas.com/sri).

## ATAS International, Inc.

Allentown, PA | Mesa, AZ | University Park, IL | Elkton, MD

[www.atas.com](http://www.atas.com) | 800.468.1441

\*Subject to minimum quantities and extended lead time. Inquire for material and panel width availability. Wind-Lok® is a registered trademark of ATAS International, Inc. Colors are as close to the actual colors as modern printing allows. Exact color chips on request; this is a requirement for all premium colors. If you have requirements or preference for colors or finishes other than shown, contact ATAS. Color availability varies by material, gauge and profile. ATAS is not responsible for colors selected from color chart. ATAS reserves the right to modify, eliminate and/or change its products without prior notification. Contact ATAS for more information. Every project is different. To the full extent permissible by law, ATAS disclaims all warranties, express or implied, including, but not limited to, implied warranties of merchantability and fitness for a particular purpose. A qualified engineer, architect or contractor should review suitability of use. Please visit [www.atas.com](http://www.atas.com) for the most up-to-date information.

© 2026 ATAS International, Inc. LRD0726 LAT320

