

MPS120-Solid Soffit Panel

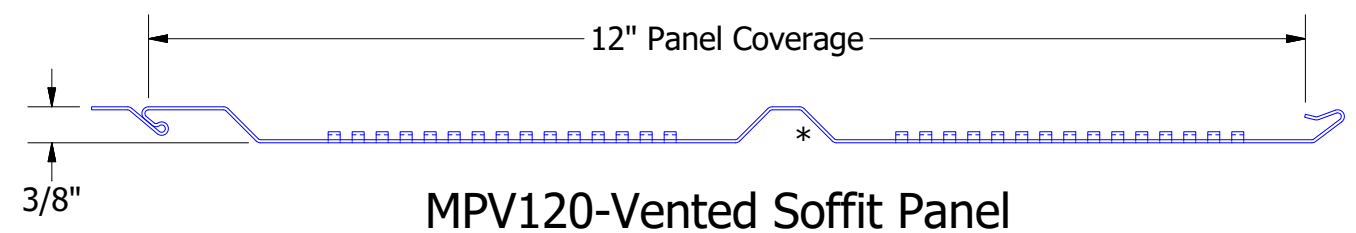

MPV120-Vented Soffit Panel

Note: * denotes color side.



ATAS INTERNATIONAL, INC
 Allentown PA
 610-395-8445
 Mesa AZ
 480-558-7210

TITLE
Wind-Lok Soffit Panel Profile Detail

					DWG. NO.	DR	KRK	DATE	6/9/2014
01	4/23/2020	Updated Detail Information	KRK		MATERIAL	APP		DATE	
REV. NO.	DATE	DESCRIPTION OF REVISION	BY	APP		SH. SIZE	B	SCALE	X:X

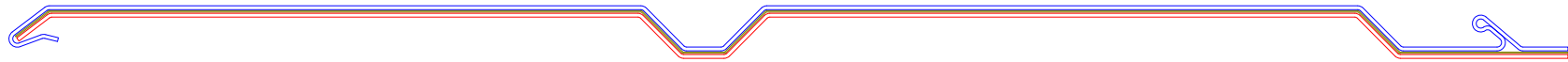
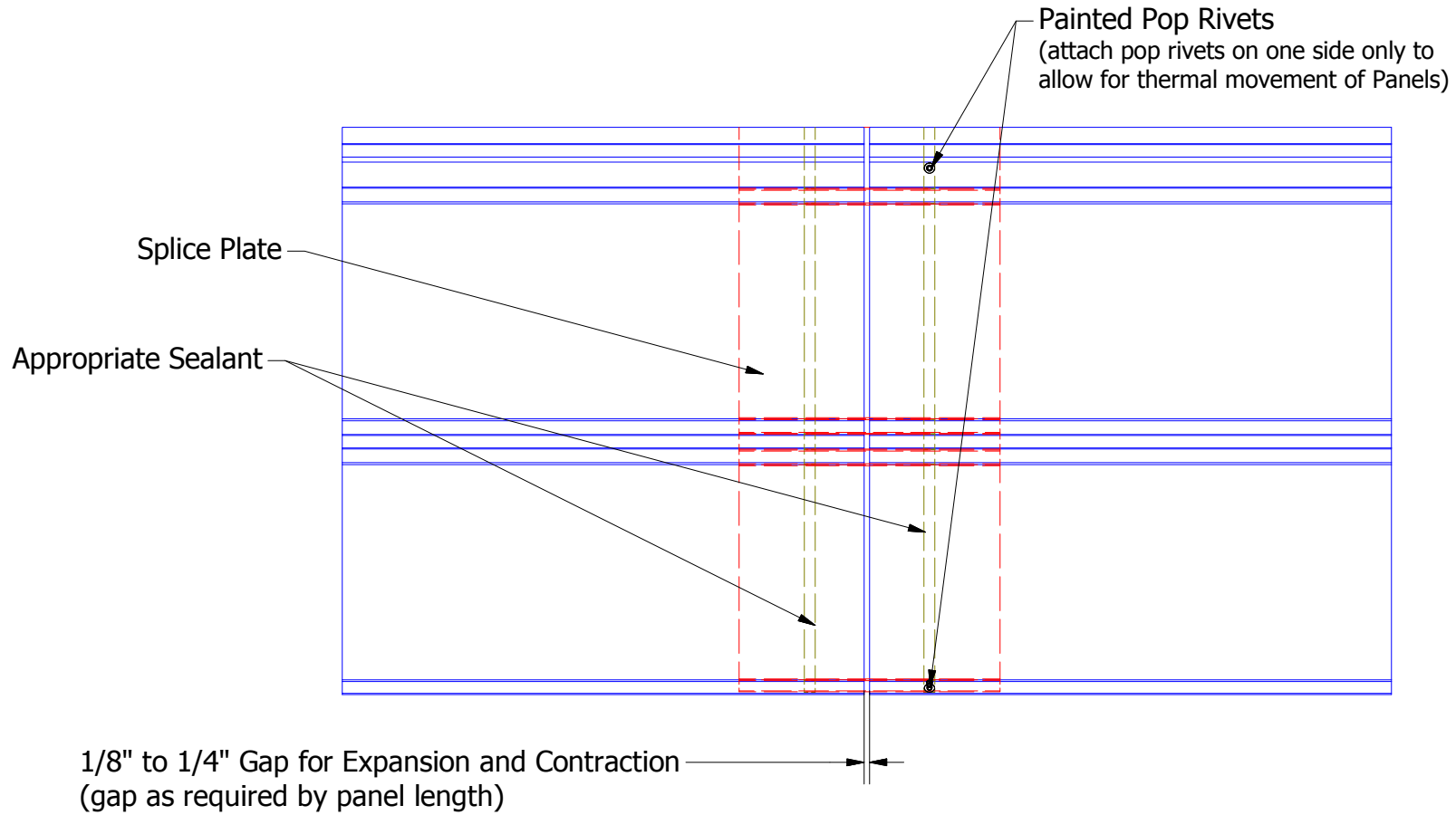

ATAS INTERNATIONAL, INC
 Allentown PA
 610-395-8445
 Mesa AZ
 480-558-7210

TITLE **Wind-Lok Soffit Splice Detail**

REV. NO.	DATE	DESCRIPTION OF REVISION	BY	APP	DWG. NO.	DR KRK	DATE 12/22/2017
					MATERIAL	APP	DATE
						SH. SIZE A	SCALE X:X

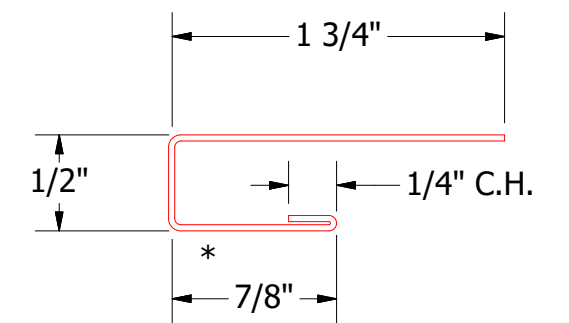
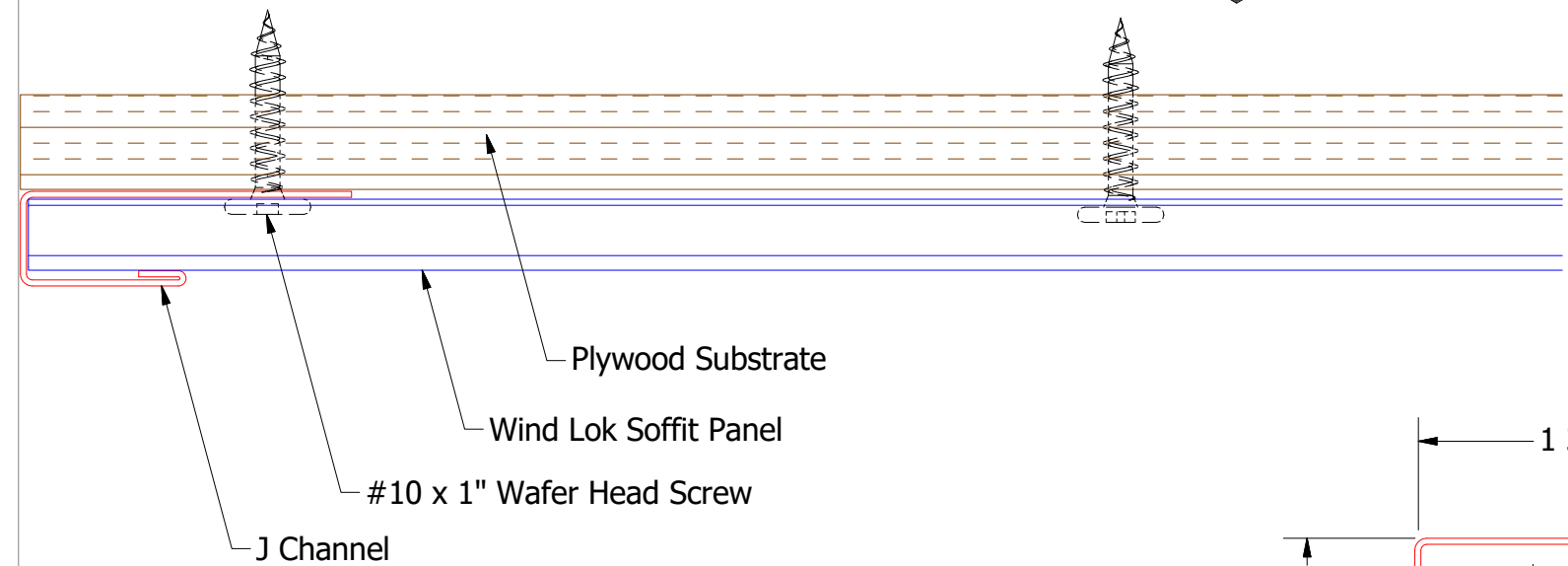
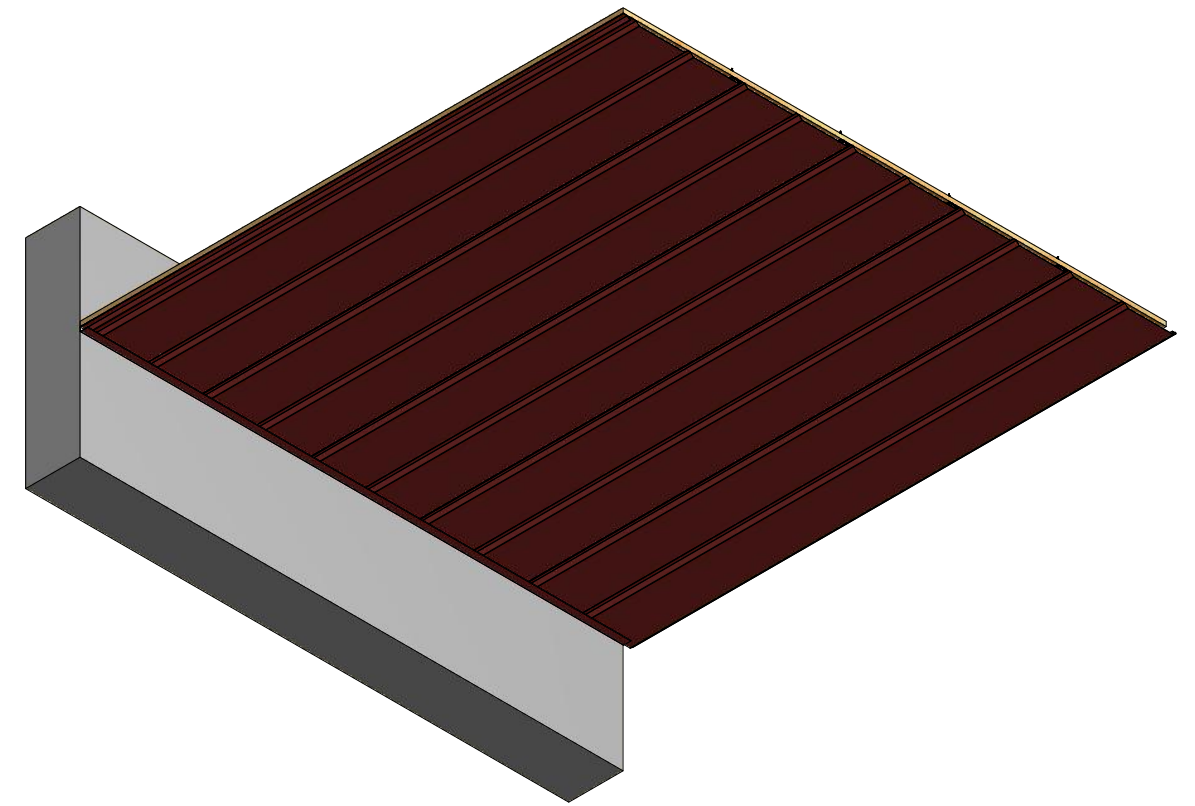

MPA012 J Channel

Note: * denotes color side.

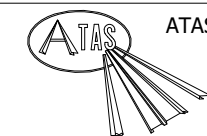

ATAS INTERNATIONAL, INC
 Allentown PA
 610-395-8445
 Mesa AZ
 480-558-7210

TITLE				Wind-Lok Soffit Endwall	
REV. NO.		DATE		DR. DATE	
				MBP 7/11/2018	
DESCRIPTION OF REVISION		BY		APP	
MATERIAL				SH. SIZE	
				B	
				SCALE	
				X:X	

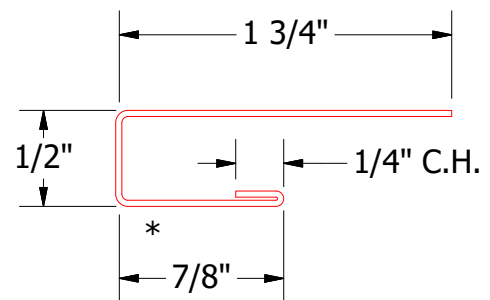
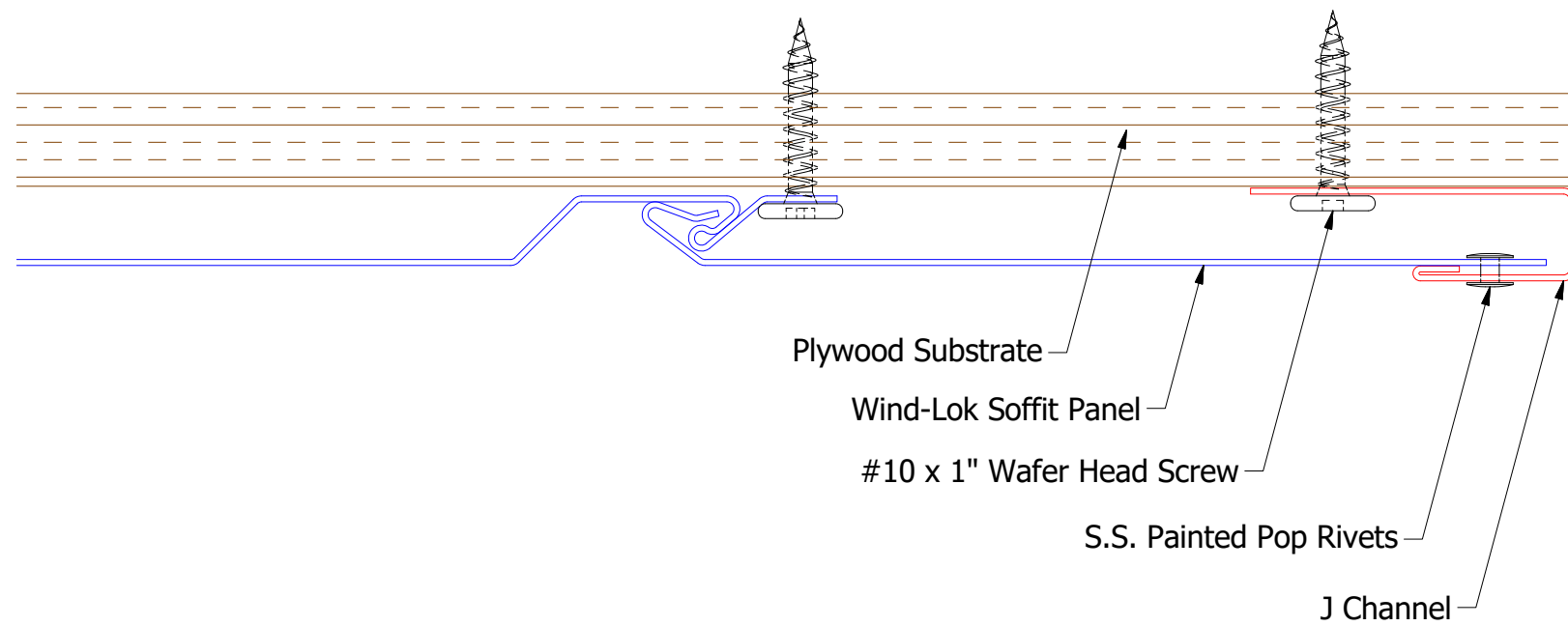
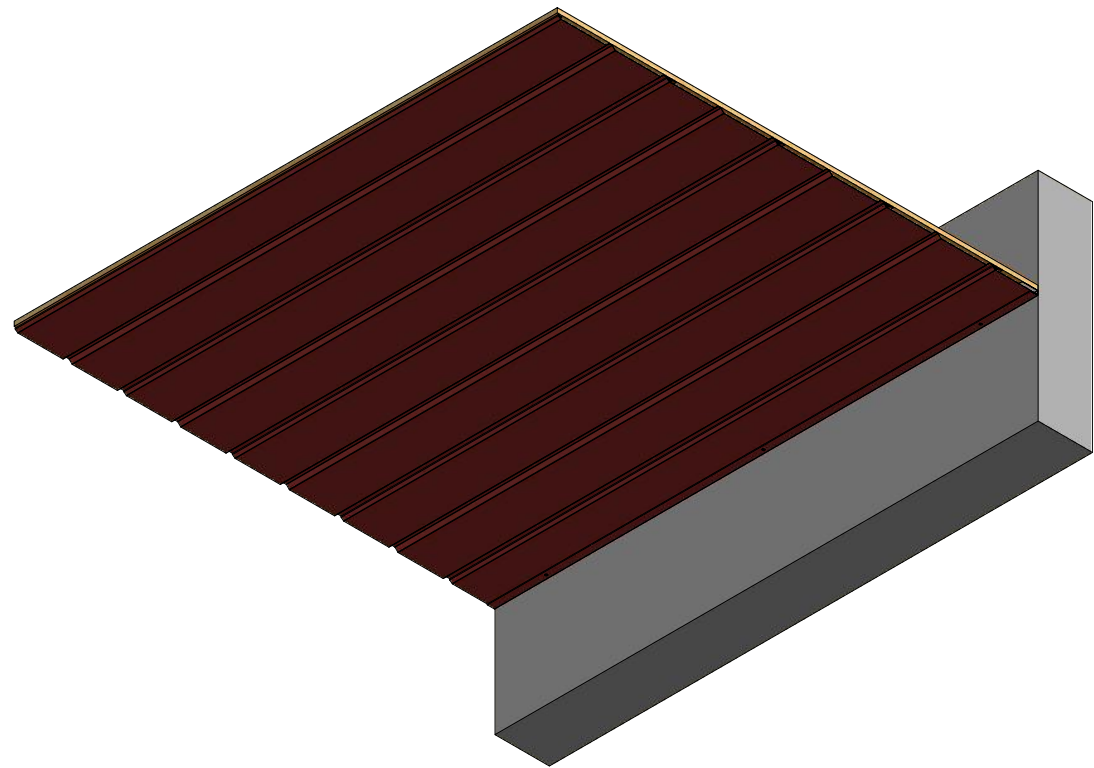

MPA012 - J Channel

Note: * denotes color side.

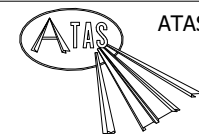

ATAS INTERNATIONAL, INC
 Allentown PA
 610-395-8445
 Mesa AZ
 480-558-7210

TITLE **Wind-Lok Soffit Ending Endwall**

REV. NO.	DATE	DESCRIPTION OF REVISION	BY	APP	DWG. NO.	DR	DATE	MBP	7/11/2018
						APP	DATE		
					MATERIAL	SH. SIZE	B	SCALE	X:X